



LIQUIFLO EQUIPMENT CO.
GARWOOD, N.J. 07027

MODEL: 2F & 2R MAG-DRIVE GEAR PUMP
DWG. NO. 2286 REV. B

SERIES
2

MOTOR FRAME	DIMENSION				
	CP	HL	HD	HV	HD
IEC 71 - B14 FACE	6.30 [160]	5.00 [127]	2.80 [71.1]	3.09 [78.6]	4.61 [117]
NEMA 48C	6.67 [169]	5.36 [136]	3.00 [76.2]	3.29 [83.6]	4.81 [122]
NEMA 56C/56HC	7.04 [179]	5.74 [146]	3.50 [88.9]	3.79 [96.3]	5.31 [135]

(SEE NOTE #1)

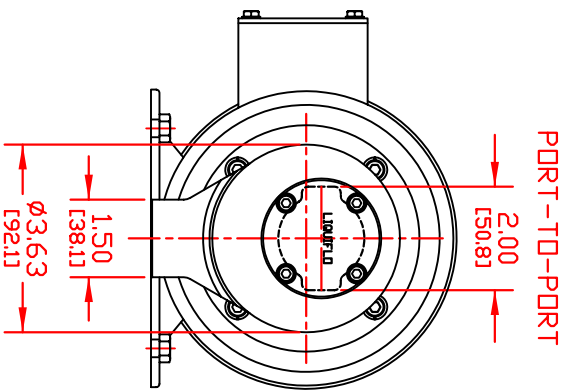
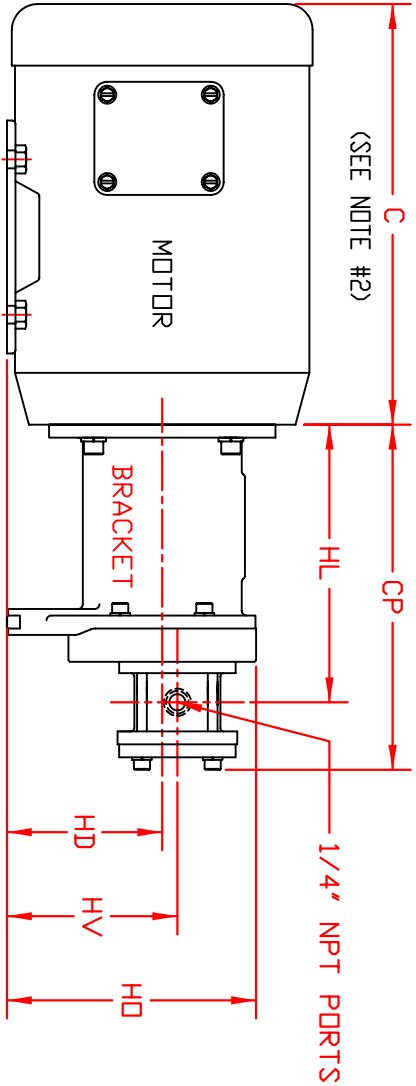

NOTES:

- 1) 'CP' DIMENSION FOR NEMA 56C/56HC MOTORS INCLUDES .375 [9.5] THICK ADAPTER PLATE (NOT SHOWN).
- 2) SEE DATA FROM MOTOR MANUFACTURER FOR 'C' DIMENSION.

