



LIQUIFLO EQUIPMENT CO.  
GARWOOD, N.J. 07027

MODEL: 41, 43, 44 & 45, MAG-DRIVE GEAR PUMP

DWG. NO. 20670 REV. ---

SERIES  
4

NEMA 48C MOTOR FRAME				
MODEL	CP	HD	HD	HV
41 & 43	6.30 [160]	3.00 [76.2]	5.60 [142]	3.50 [88.9]
44 & 45	6.80 [173]	3.00 [76.2]	5.60 [142]	3.50 [88.9]

IEC 71 (B14 FACE) MOTOR FRAME				
MODEL	CP	HD	HD	HV
41 & 43	5.93 [151]	2.80 [71.1]	5.40 [137]	3.30 [83.8]
44 & 45	6.43 [163]	2.80 [71.1]	5.40 [137]	3.30 [83.8]

NEMA 56C/56HC MOTOR FRAMES				
MODEL	CP	HD	HD	HV
41 & 43	6.67 [169]	3.50 [88.9]	6.10 [155]	4.00 [102]
44 & 45	7.17 [182]	3.50 [88.9]	6.10 [155]	4.00 [102]

PORT CONNECTIONS				
MODEL	X	2X	SIZE-NPT	SIZE-BSP
41 & 43	.75 [19]	1.50 [38.1]	1/4	3/8
44 & 45	.75 [19]	1.50 [38.1]	3/8	3/8

(SEE NOTE #1)

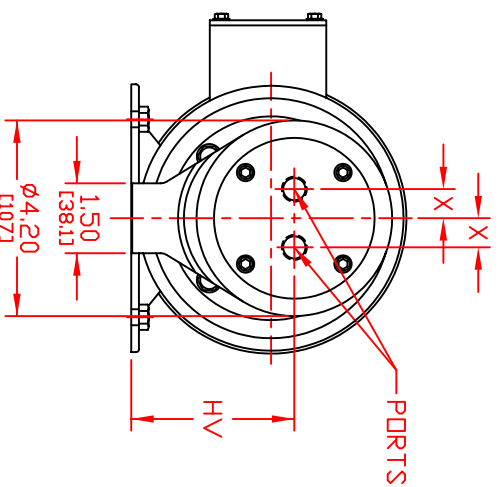
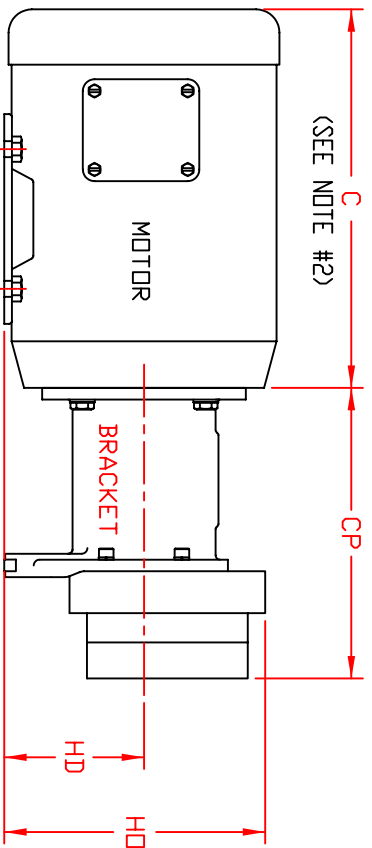

- NOTES:  
1) 'CP' DIMENSION FOR NEMA 56C/56HC MOTORS INCLUDES .375 [9.5] THICK ADAPTER PLATE (NOT SHOWN).  
2) SEE DATA FROM MOTOR MANUFACTURER FOR 'C' DIMENSION.

INCH  
[MM]