

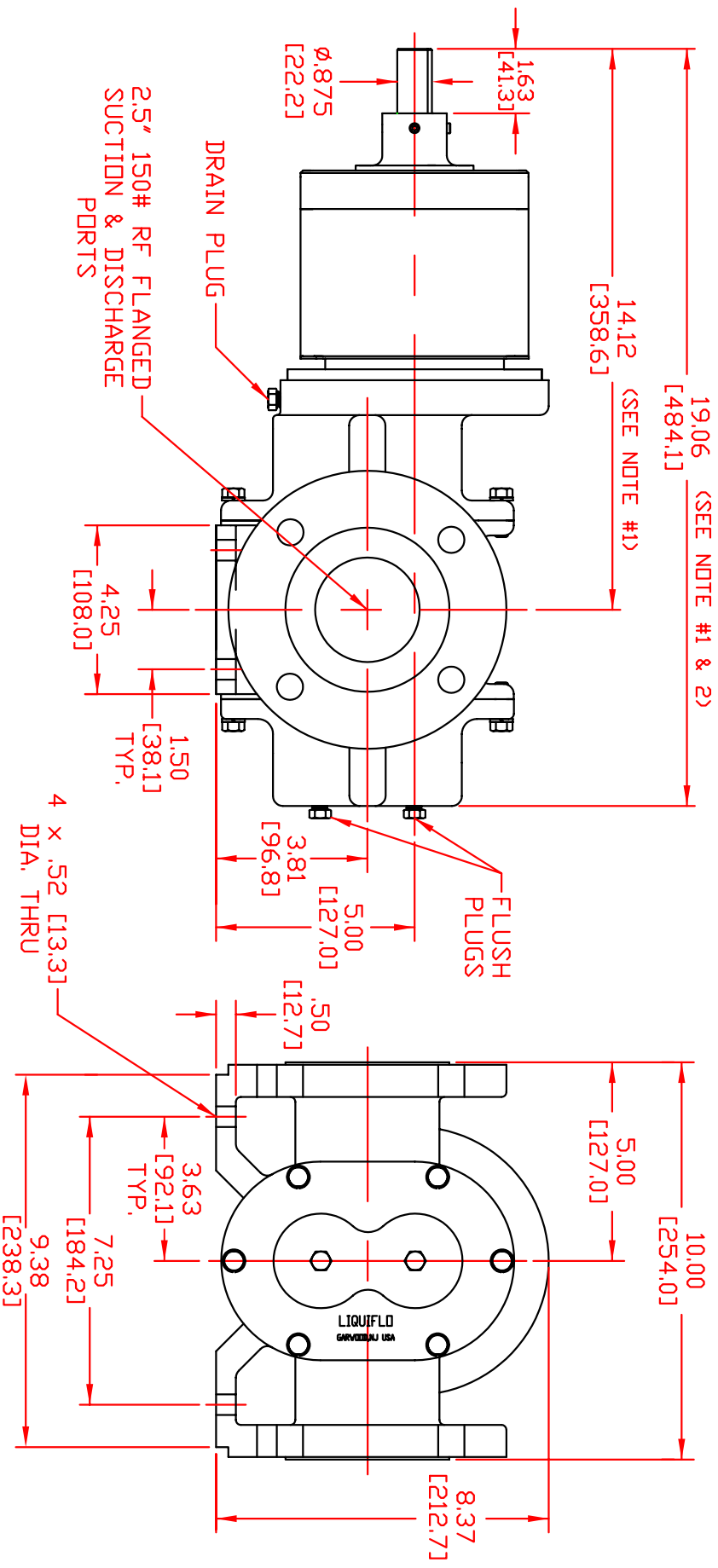

LIQUIFLO EQUIPMENT CO.
GARWOOD, N.J. 07027

MODEL: ROTORGEAR MAG-DRIVE, 314F BARE PUMP,
FLANGED PORTS
DWG. NO. 20177 REV. B

SERIES
3



NOTES:
1) DIMENSION BASED ON MCJ/MCK MAGNETIC COUPLING.
2) ADD .31 [7.9] FOR BEARING FLUSH PLUGS.

