

SERIES

H-Series  
3-Series

MODEL

H9R  
39R

CONFIGURATION

Sealed or Mag-Drive Gear Pump  
Close-Coupled Base-Mounted Version  
with NPT or BSPT Ports

SEAL TYPE

Single Mechanical Seal, Double Mechanical Seal  
or Mag-Drive (Sealless)

UNITS: inches [mm]

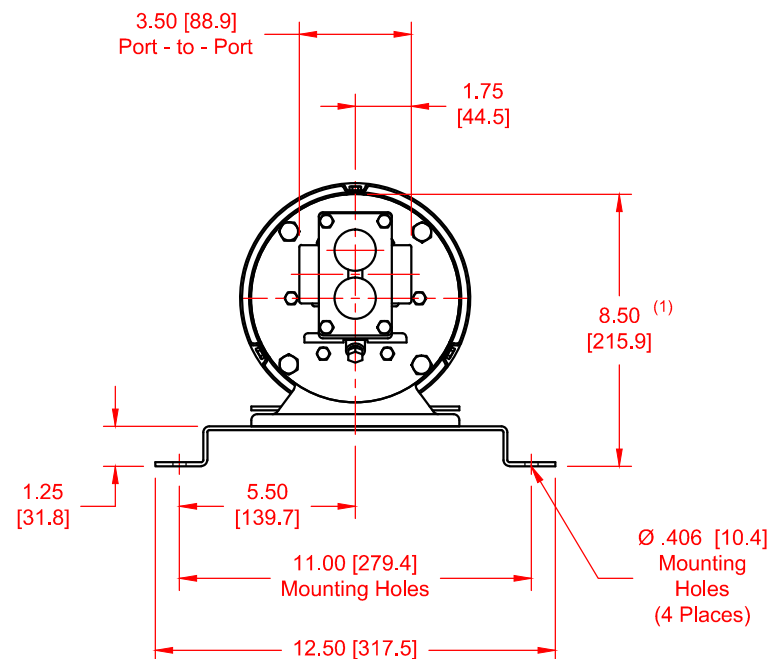
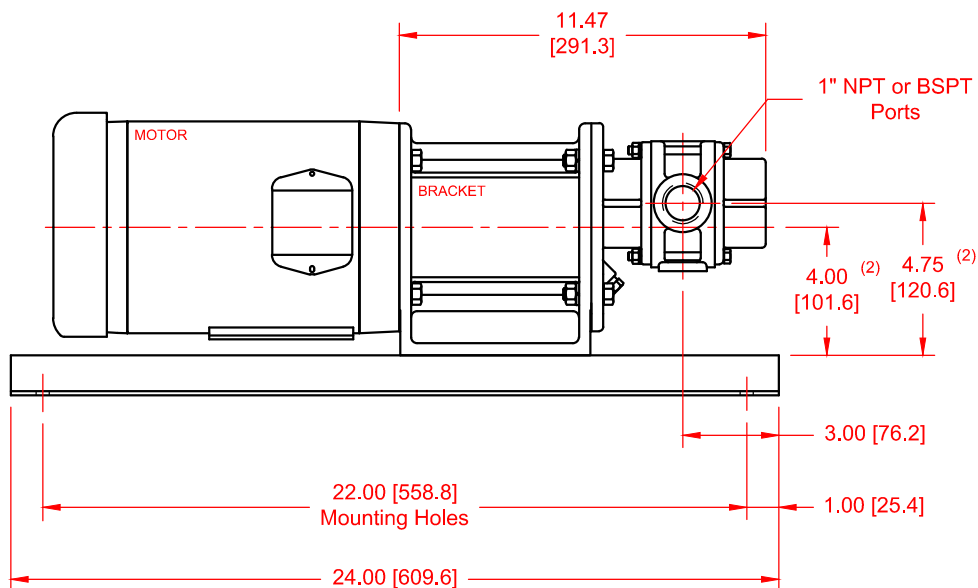

NOTES:

- 1) Dimension to top of Bracket.
- 2) Applies for NEMA 56C, 143TC, 145TC & IEC 71-B5 Motors.

DWG. NO. 20418 REV.