

UNITS: inches [mm]

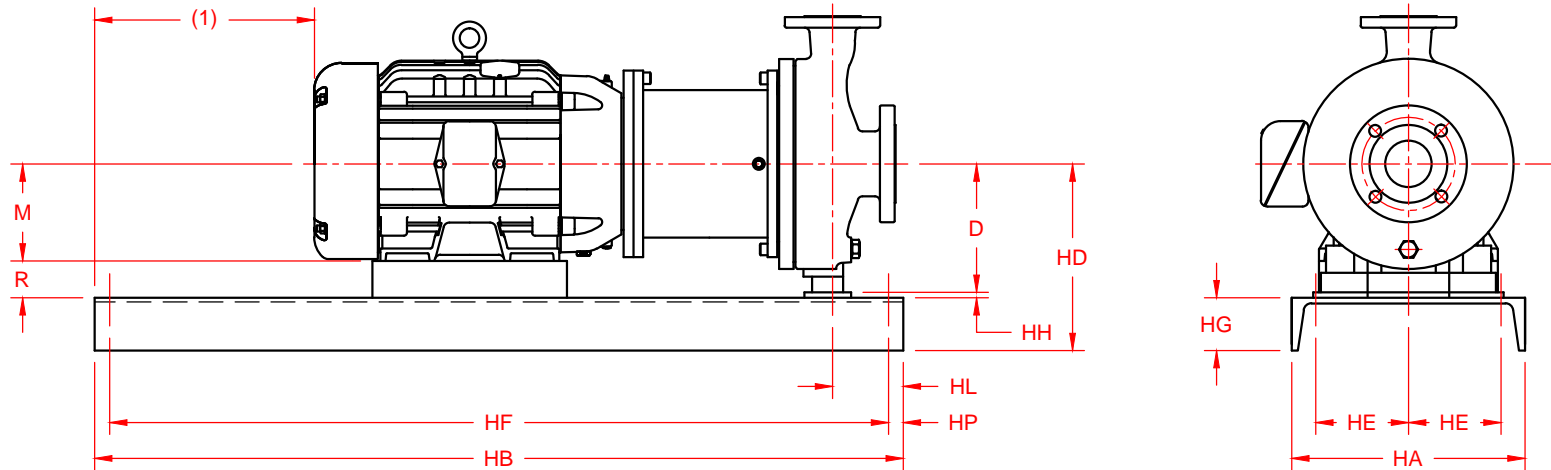

| MOTOR FRAME | M | R | HA | HB | HD MAX. D=5.25 | HE | HF | HG MAX. | HH | HL | HP | BASE PLATE PART NO. |
|-------------|------|------|----|----|-------------------|-----|------|---------|------|-----|------|---------------------|
| 56C | 3.50 | 1.75 | 15 | 38 | 8.65 | 6.0 | 35.5 | 3.4 | 0 | 4.5 | 1.25 | 3519-050 |
| 143T/145T | 3.50 | 1.75 | 15 | 38 | 8.65 | 6.0 | 35.5 | 3.4 | 0 | 4.5 | 1.25 | 3519-050 |
| 182T/184T | 4.50 | 0.75 | 15 | 38 | 8.65 | 6.0 | 35.5 | 3.4 | 0 | 4.5 | 1.25 | 3519-050 |
| 213T/215T | 5.25 | 0 | 15 | 38 | 8.65 | 6.0 | 35.5 | 3.4 | 0 | 4.5 | 1.25 | 3519-050 |
| 254T/256T | 6.25 | 0 | 15 | 38 | 9.65 | 6.0 | 35.5 | 3.4 | 1 | 4.5 | 1.25 | 3519-050 |
| 284T/286T | 7.00 | 0 | 15 | 38 | 10.40 | 6.0 | 35.5 | 3.4 | 1.75 | 4.5 | 1.25 | 3519-050 |
| IEC 71 | 2.80 | 2.45 | 15 | 38 | 8.65 | 6.0 | 35.5 | 3.4 | 0 | 4.5 | 1.25 | 3519-050 |
| IEC 80 | 3.15 | 2.10 | 15 | 38 | 8.65 | 6.0 | 35.5 | 3.4 | 0 | 4.5 | 1.25 | 3519-050 |
| IEC 90 | 3.54 | 1.71 | 15 | 38 | 8.65 | 6.0 | 35.5 | 3.4 | 0 | 4.5 | 1.25 | 3519-050 |
| IEC 100 | 3.94 | 1.31 | 15 | 38 | 8.65 | 6.0 | 35.5 | 3.4 | 0 | 4.5 | 1.25 | 3519-050 |
| IEC 112 | 4.41 | .84 | 15 | 38 | 8.65 | 6.0 | 35.5 | 3.4 | 0 | 4.5 | 1.25 | 3519-050 |
| IEC 132 | 5.20 | 0.80 | 15 | 38 | 9.40 | 6.0 | 35.5 | 3.4 | 0.75 | 4.5 | 1.25 | 3519-050 |

NOTES:

1) Motor back should not extend beyond base.