

# Liquiflo

EQUIPMENT COMPANY

## Group I 8" MC Close-Coupled

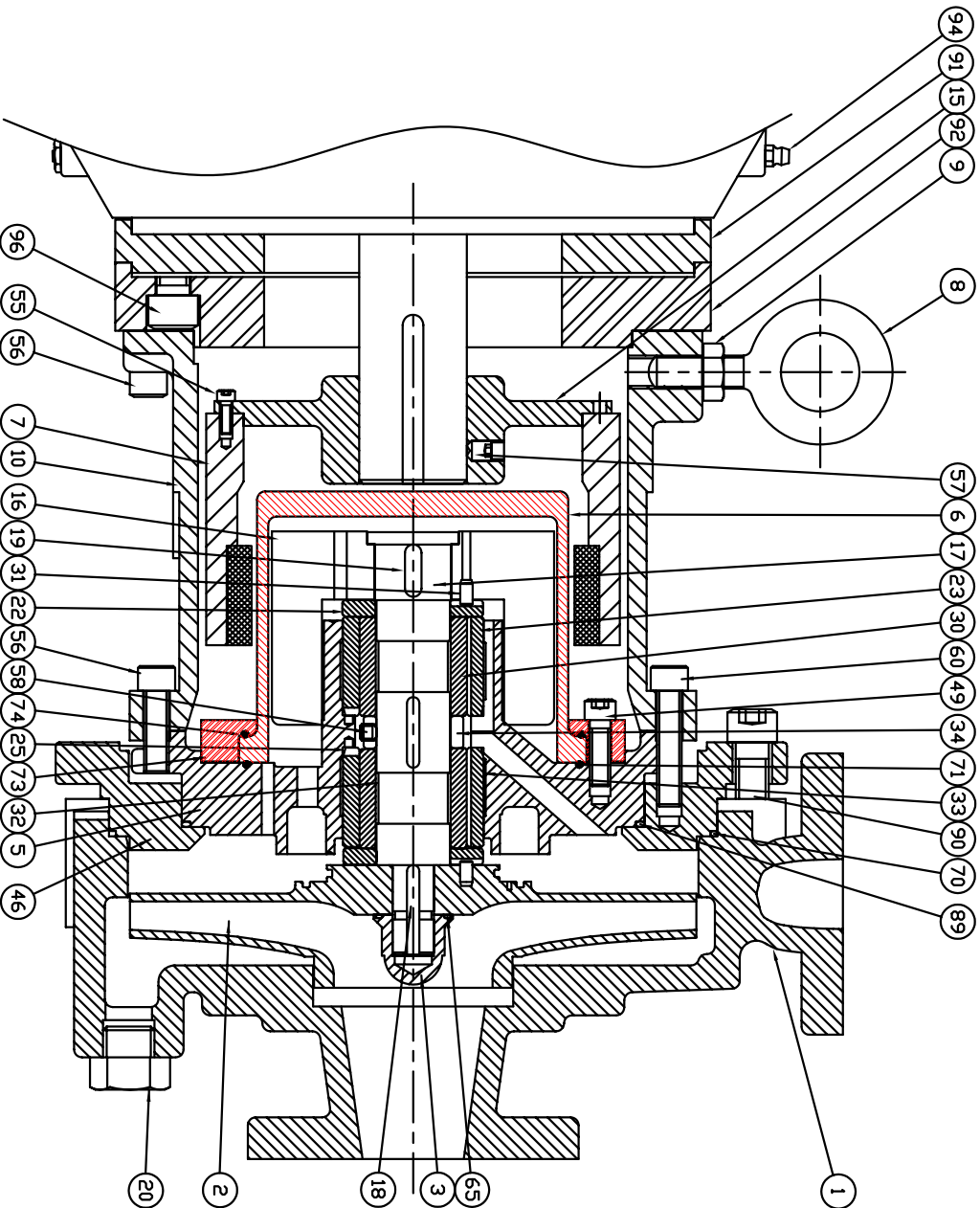

- NOTES:
1. DRAWING SHOWN WITH CERAMIC CONTAINMENT SHELL
  - \*2. WHEN USING METALLIC CAN ITEM 49 IS 3/4" LONG
  - \*3. WHEN USING METALLIC CAN ITEM 74 IS NOT USED

PARTS LIST ( E3506CC )		
ITEM	REQ'D	DESCRIPTION
1	1	CASING
2	1	IMPELLER, CLOSED
3	1	NUT, IMPELLER
5	1	HOUSING, BEARING
6	1	CONTAINMENT SHELL (CERAMIC)
6	1	CONTAINMENT SHELL (METALLIC)
7	1	OUTER MAGNET
8	1	EYEBOLT
9	1	NUT, EYEBOLT
10	1	MOUNTING BRACKET
15	1	HUB, OUTER MAGNET
16	1	INNER MAGNET
17	1	SHAFT
18	1	KEY, IMPELLER
19	1	KEY, INNER MAGNET
20	1	DRAIN PLUG (1/2 NPT)
22	2	BEARING, THRUST
23	2	BEARING, RADIAL
25	4	PIN, SLEEVE BEARING
30	2	BEARING, SLEEVE
31	2	PIN, THRUST BEARING
32	2	TOLERANCE RING, SHAFT
33	2	TOLERANCE RING, BRG. HSG.
34	1	SPACER (BEARINGS)
46	1	ADAPTER, CASING
49	8	5/16-24 X 1 SHCS
55	8	#8-32 X 1/2 SHCS
56	6	3/8-16 X 1 1/4 SHCS
57	2	5/16-24 X 3/8 SHSS
58	1	1/4-28 X 1/4 SHSS
60	8	3/8-24 X 1 3/4 SHCS
65	1	D-RING, IMPELLER NUT
70	1	D-RING, CASING
71	1	D-RING, CONT. SHELL
73	1	FLANGE, CONT. SHELL
74	1	D-RING, CONT. SHELL FLANGE
89	1	D-RING, CASING ADAPTER
90	8	1/2-13 X 1 3/4 SHCS
91	1	ADAPTER, MOTOR
92	1	ADAPTER, MOUNTING BRACKET
94	1	MOTOR (254/256TC)
96	4	1/2-13 X 1 3/4 SHCS

Telephone: (908) 518-0777

443 North Avenue, Garwood, NJ 07027, USA  
 Fax: (908) 518-1847

Internet: <http://www.liquiflo.com>