

SERIES

ENDURA

GROUP

11

CONFIGURATION

Centrifugal Pump  
Close-Coupled Version  
Mag. Drive (Old)

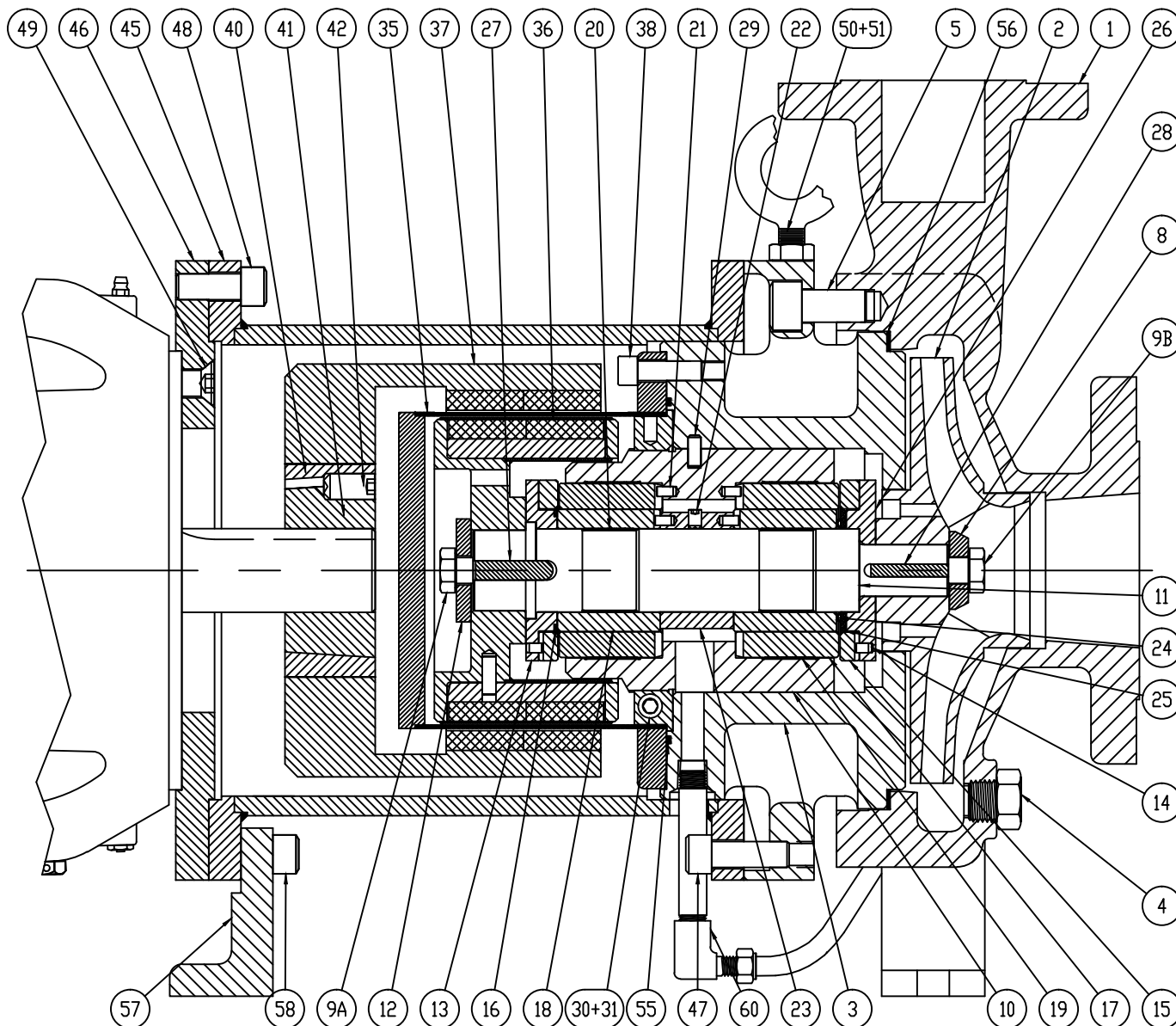

PARTS LIST

ITEM	QTY	DESCRIPTION
1	1	CASING 3 x 2 x 8, 150# RF SERRATED
		CASING 4 x 3 x 8, 150# RF SERRATED
		CASING 3 x 2 x 10, 150# RF SERRATED
		CASING 4 x 3 x 10, 150# RF SERRATED
2	1	IMPELLER 3 x 2 x 8 (CLOSED)
		IMPELLER 4 x 3 x 8 (CLOSED)
		IMPELLER 3 x 2 x 10 (CLOSED)
		IMPELLER 4 x 3 x 10 (CLOSED)
3	1	CASING COVER 3 x 2 x 8
		CASING COVER 4 x 3 x 8
		CASING COVER 3 x 2 x 10
		CASING COVER 4 x 3 x 10
4	1	DRAIN PLUG, 1/2 NPT
5	8	5/8-11 x 1-1/4 SHCS (BOLT, CASING 8")
	12	5/8-11 x 1 SHCS (BOLT, CASING 10")
8	1	WASHER, IMPELLER
9A	1	1/2-13 x 1-1/4 HHCS (BOLT, SHAFT)
9B	1	
10	1	BEARING HOUSING
11	1	SHAFT
12	1	WASHER, INNER MAGNET
13	1	HOLDER, BEARING THRUST (MAGNET END)
14	2	PIN, BEARING THRUST
15	2	BEARING, THRUST
16	1	WASHER, BEARING THRUST (MAGNET END)
17	2	BEARING, STATIONARY
18	2	BEARING, ROTATING
19	2	TOLERANCE RING, BEARING HOUSING
20	2	TOLERANCE RING, SHAFT
21	4	PIN, SLEEVE BEARING
22	1	1/4-28 x 3/8 SHSS-HD (SET SCREW, SPACER)
23	1	SPACER, SLEEVE BEARING
24	1	SPRING, BEARING PRELOAD
25	1	WASHER, BEARING THRUST (IMPELLER END)
26	1	HOLDER, BEARING THRUST (IMPELLER END)
27	1	KEY, INNER MAGNET
28	1	KEY, IMPELLER
29	1	PIN, BEARING HOUSING
30	1	LOCKNUT, BEARING HOUSING
31	1	5/16-24 x 1 SHCS (BOLT, LOCKNUT)
35	1	CONTAINMENT CAN METALIC
36	1	INNER MAGNET 2"
		INNER MAGNET 3"
37	1	OUTER MAGNET 2" (METALIC CAN)
		OUTER MAGNET 3" (METALIC CAN)
38	8	3/8-24 x 1-1/4 SHCS (BOLT, CONT. CAN)
40	1	ADAPTER, TAPER LOCK
41	1	BUSHING, TAPER LOCK (254/256TC)
42	2	1/2-13 x 1 SHSS (SETSCREW, TAPER LOCK)
45	1	BRACKET
46	1	ADAPTER, MOTOR (254/256TC)
47	4	1/2-13 x 1-1/2 SHCS (BOLT, CASING COVER)
48	4	1/2-13 x 1-1/4 SHCS (BOLT, BRACKET)
49	4	1/2-13 x 1-1/2 FHCS (BOLT, ADAPTER)
50	2	EYEBOLT
51	2	NUT, EYEBOLT
55	1	O-RING, CONTAINMENT CAN (2-165)
56	1	GASKET, CASING
57	1	FOOT, BRACKET
58	2	1/2-13 x 1-1/4 SHCS (BOLT, FOOT BRACKET)
		NIPPLE 1/4 NPT (BEARING FLUSH ASSEMBLY)
		STRAIGHT FITTING (BEARING FLUSH ASSEMBLY)
		TUBING #3/8" (BEARING FLUSH ASSEMBLY)
60	1	MALE ELBOW (BEARING FLUSH ASSEMBLY)