

# Liquiflo

EQUIPMENT COMPANY

## Group II MC Close-Coupled

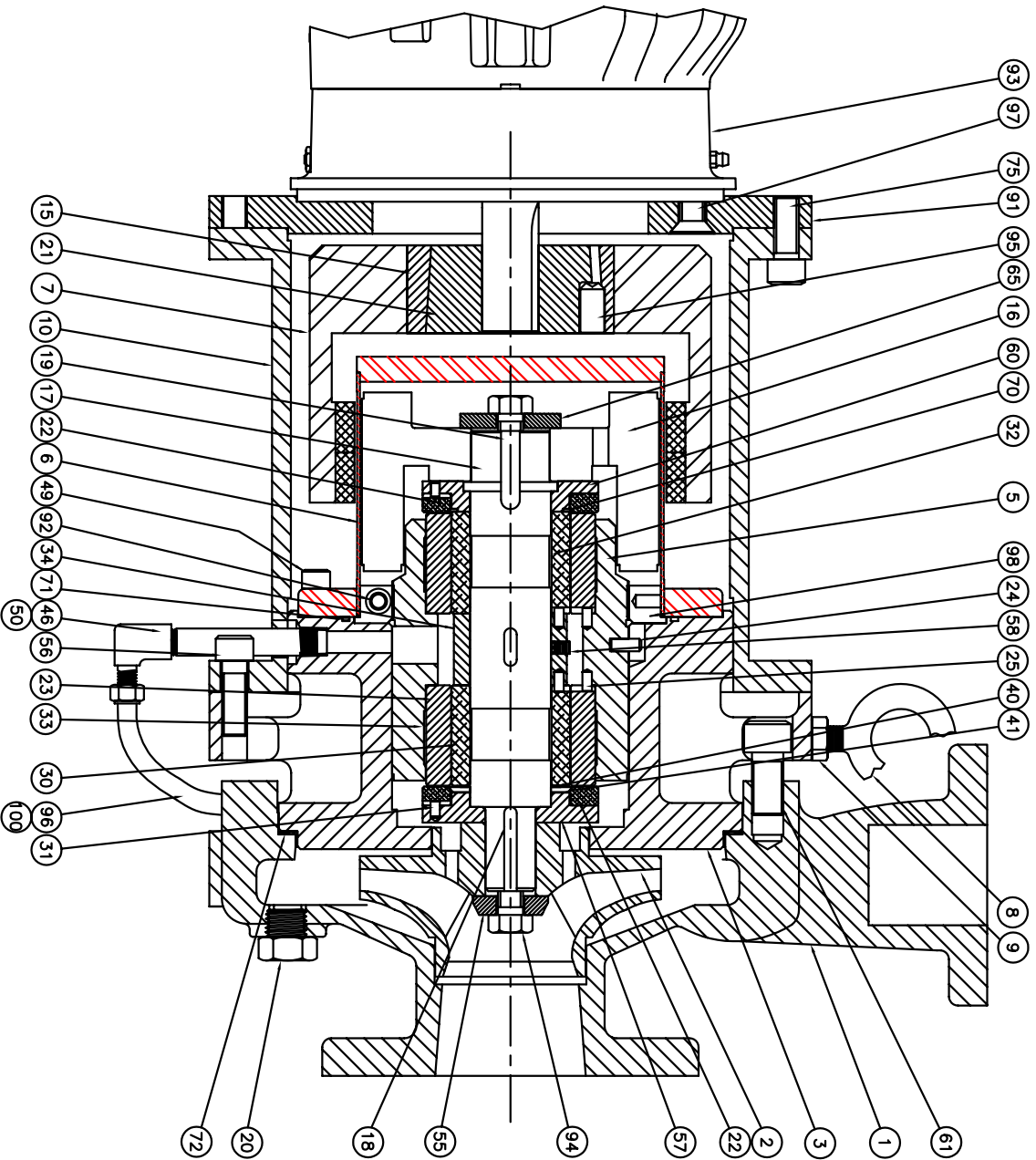

| ITEM | REQD | DESCRIPTION                      |
|------|------|----------------------------------|
| 1    | 1    | CASING                           |
| 2    | 1    | IMPELLER                         |
| 3    | 1    | COVER CASING                     |
| 5    | 1    | BEARING HOUSING                  |
| 6    | 1    | CONTAINMENT SHELL                |
| 7    | 1    | OUTER MAGNET                     |
| 8    | 2    | EYEBOLT                          |
| 9    | 1    | NUT, EYEBOLT                     |
| 10   | 1    | MOUNTING BRACKET                 |
| 15   | 1    | ADAPTER, TAPER LOCK              |
| 16   | 1    | INNER MAGNET                     |
| 17   | 1    | SHAFT                            |
| 18   | 1    | KEY, IMPELLER                    |
| 19   | 1    | KEY, INNER MAGNET                |
| 20   | 1    | DRAIN PLUG (1/2 NPT)             |
| 21   | 1    | BUSHING, TAPER LOCK              |
| 22   | 2    | BEARING, THRUST                  |
| 23   | 2    | BEARING, RADIAL                  |
| 24   | 1    | PIN, BEARING HOUSING             |
| 25   | 4    | PIN, SLEEVE BEARING              |
| 30   | 2    | BEARING, SLEEVE                  |
| 31   | 2    | PIN, THRUST BEARING              |
| 32   | 2    | TOLERANCE RING, SHAFT            |
| 33   | 2    | TOLERANCE RING, BRG. HSG.        |
| 34   | 1    | SPACER (BEARINGS)                |
| 40   | 1    | SPRING (PRELOAD)                 |
| 41   | 1    | WASHER, THRUST BRG., IMP. END    |
| 46   | 1    | NIPPLE (OPTIONAL FLUSH)          |
| 49   | 8    | 3/8-24 X 1 1/2 SHCS              |
| 50   | 1    | STRAIGHT FITTING (OPT. FLUSH)    |
| 55   | 1    | WASHER, IMPELLER                 |
| 56   | 4    | 1/2-13 X 1 1/2 SHCS              |
| 57   | 1    | HOLDER, THRUST BRG., IMP. END    |
| 58   | 1    | 1/4-28 X 3/8 SHSS                |
| 60   | 1    | HOLDER, THRUST BRG., MAG. END    |
| 61   | 8/12 | 5/8-11 X 1 1/4 SHCS              |
| 65   | 1    | WASHER, INNER MAGNET             |
| 70   | 1    | WASHER, THRUST BRG., MAG. END    |
| 71   | 1    | O-RING, CONTAINMENT SHELL        |
| 72   | 1    | GASKET, CASING                   |
| 75   | 4    | 1/2-13 X 1 1/4 SHCS              |
| 91   | 1    | ADAPTER, MOTOR                   |
| 92   | 1    | 5/16-24 X 1 SHCS                 |
| 93   | 1    | MOTOR (182/184TC)                |
| 94   | 2    | 1/2-13 X 1 1/4 HHCS              |
| 95   | 2    | 1/2 X 1 SHSS                     |
| 96   | 1    | 3/8 DIA. TUBING (OPT. FLUSH)     |
| 97   | 4    | 1/2-13 X 1 1/2 FLT. HD. HEX SDC. |
| 98   | 1    | LOCKNUT, BEARING HOUSING         |
| 100  | 1    | MALE ELBOW (OPT. FLUSH)          |