

SERIES	MODEL	CONFIGURATION	SEAL TYPE
4-Series	41, 43, 44, 45	Mag-Drive Gear Pump Close-Coupled with NPT or BSPT Ports.	Mag-Drive (Sealless)

UNITS: inches [mm]

MOTOR	MODEL	"P"	"A"	"B"	"C"	"D"	"E"	"F"	"G"
IEC 71 B14	41 & 43	1/4" NPT or 3/8" BSPT	5.80 [147.3]	5.40 [137.0]	2.80 [71.0]	3.30 [83.7]	7.57 [192.3]	3.54 [90.0]	4.41 [112.0]
	44 & 45	3/8" NPT or 3/8" BSPT	6.30 [160.0]	5.40 [137.0]	2.80 [71.0]	3.30 [83.7]	8.07 [205.0]	3.54 [90.0]	4.41 [112.0]
IEC80 B14 & 48C	41 & 43	1/4" NPT or 3/8" BSPT	6.30 [160.0]	5.60 [142.2]	3.00 [76.2]	3.50 [88.9]	8.62 [218.9]	2.75 [69.9]	4.25 [108.0]
	44 & 45	3/8" NPT or 3/8" BSPT	6.80 [172.8]	5.60 [142.2]	3.00 [76.2]	3.50 [88.9]	9.12 [231.6]	2.75 [69.9]	4.25 [108.0]
56C	41 & 43	1/4" NPT or 3/8" BSPT	6.68 [169.7] ⁽¹⁾	6.10 [154.9]	3.50 [88.9]	4.00 [101.6]	9.24 [234.7]	3.00 [76.2]	4.88 [123.8]
	44 & 45	3/8" NPT or 3/8" BSPT	7.18 [182.4] ⁽¹⁾	6.10 [154.9]	3.50 [88.9]	4.00 [101.6]	9.74 [247.4]	3.00 [76.2]	4.88 [123.8]

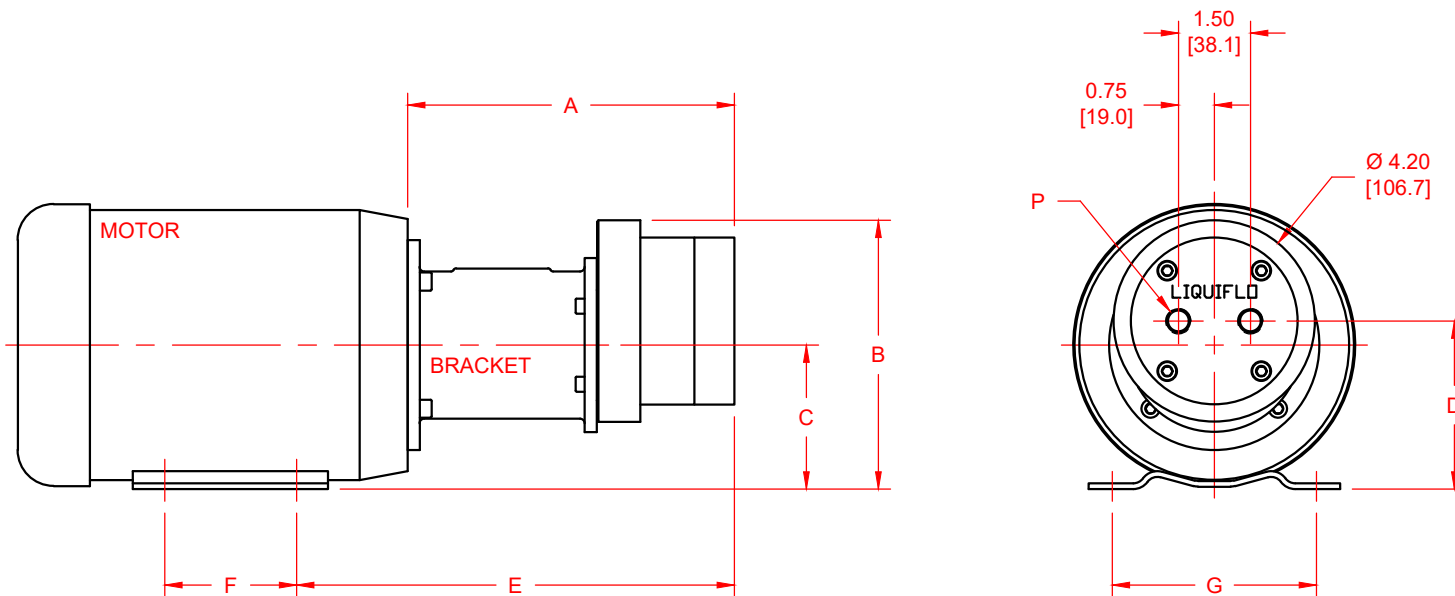

NOTES:

1) Dimension "A" for NEMA 56C motors with legacy blue epoxy-painted bracket includes .375" [9.5] thick adapter plate between bracket and motor (not shown).