

SERIES	MODEL	CONFIGURATION
Accessories	Heat Jacket	M0 - M8 Sealed or Mag-Drive ANSI or DIN Flanges or Threaded

UNITS: inches [mm]

	Dimensions									
	"A"	"B"	"C"	"D"	"E"	"F"	"G"	"H"	"I"	"P"
M0-M3	6.00 [152.4]	7.05 [179.1]	7.00 [177.8]	3.93 [99.7]	1.68 [42.5]	4.50 [114.3]	1.13 [28.6]	2.94 [74.6]	2.38 [60.3]	3/8 NPT
M4	6.00 [152.4]	7.05 [179.1]	7.00 [177.8]	3.93 [99.7]	1.68 [42.5]	4.50 [114.3]	1.13 [28.6]	3.38 [85.7]	2.59 [65.9]	3/8 NPT
M5	6.00 [152.4]	7.05 [179.1]	7.00 [177.8]	3.93 [99.7]	1.68 [42.5]	4.50 [114.3]	1.13 [28.6]	4.00 [101.6]	3.38 [85.7]	3/8 NPT
M6	6.00 [152.4]	7.05 [179.1]	7.00 [177.8]	3.93 [99.7]	1.68 [42.5]	4.50 [114.3]	1.13 [28.6]	4.38 [111.1]	3.56 [90.5]	3/8 NPT
M7	6.00 [152.4]	7.05 [179.1]	7.00 [177.8]	3.93 [99.7]	1.68 [42.5]	4.50 [114.3]	1.13 [28.6]	4.75 [120.7]	3.75 [95.3]	3/8 NPT
M8	6.00 [152.4]	7.05 [179.1]	7.00 [177.8]	3.93 [99.7]	1.68 [42.5]	4.50 [114.3]	1.13 [28.6]	5.25 [133.4]	4.00 [101.6]	3/8 NPT

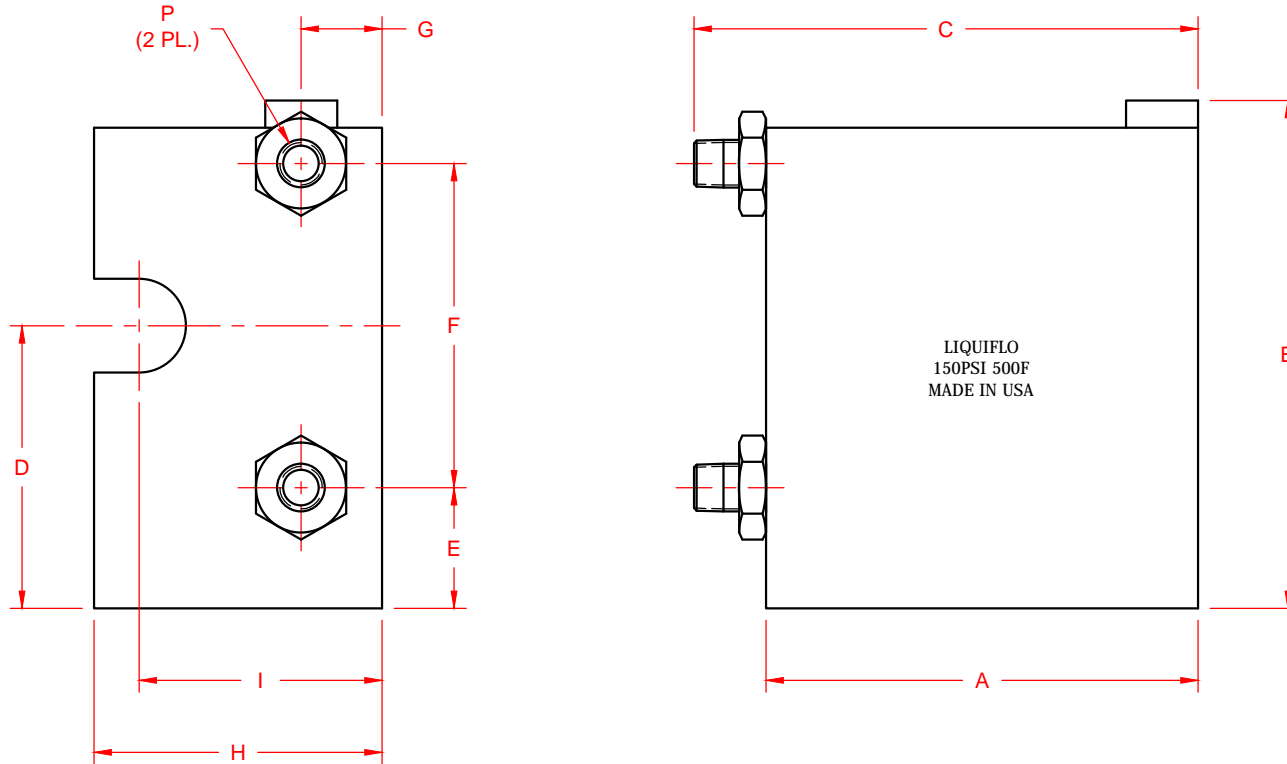

NOTES:

- 1) Body of bar stock aluminum alloy grade 6061-T6511.
- 2) Heat exchanger of 316 stainless steel.
- 3) Connections are 316 stainless steel male NPT.
- 3) Jacket rated for 150 psig service / 500°F.